

Clarion

Owner's manual

使用说明书

■ Contents

English

1. FEATURES.....	2
2. CONTROLS.....	3
3. BUTTON TERMINOLOGY.....	3
4. CASSETTE PRECAUTIONS AND CARE.....	4
5. OPERATION.....	4
6. TROUBLESHOOTING.....	8
7. ERROR DISPLAYS.....	8
8. SPECIFICATIONS.....	9

■ 目录

中文

1. 性能.....	11
2. 控制器.....	3
3. 按键名称.....	12
4. 盒式磁带用前须知和保养.....	13
5. 操作方法.....	13
6. 故障排除.....	17
7. 错误显示.....	17
8. 规格.....	封底

AX330

AM/FM CASSETTE PLAYER
WITH CD CHANGER CONTROL

AM/FM 盒式磁带放音机
带 CD 换片机控制器

C-BUS

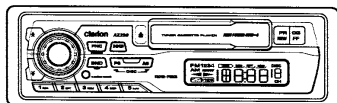

INFORMATION FOR USERS:

CHANGES OR MODIFICATIONS TO THIS PRODUCT NOT APPROVED BY THE MANUFACTURER WILL VOID THE WARRANTY AND WILL VIOLATE FCC APPROVAL.

1. FEATURES

Tuner

Electronic Quartz-Locked PLL Tuning
AM/FM Bands—1 AM, 4 FM
20 FM/5 AM Touchbutton Memory
Seek Up/Down Tuning
Preset Station Scan (PS)
Automatic Station Store (AS)
MAGI-TUNE FM Reception System

Tape

Auto Reverse
Locking FF/REW
Hard Permalloy Dual Gutter Head

Audio

Electronic Audio Controls
(Volume/Bass/Treble/Balance/ Fader)
4-Way Balance Controls
Z-Enhancer with 3 Mode Selector
160 W (40 W × 4) Maximum Power Output

General

Night Illumination
Digital Quartz Clock
Power ANT Turn-On Trigger
Full Information LCD Display
Monitor Mode
DIN Chassis

Chassis

DIN Chassis with ISO Mounting Capability
Dimensions:
178mm Width × 50mm Height × 152mm
Depth

Be sure to unfold and read the next page.

请务必展开并阅读下一页。

2. CONTROLS / 控制器

Note: Be sure to unfold this page and refer to the front diagrams as you read each chapter.

注意：您在阅读以下各个章节时，请展开本页，并参照这些前视图。

SOURCE UNIT / 主机

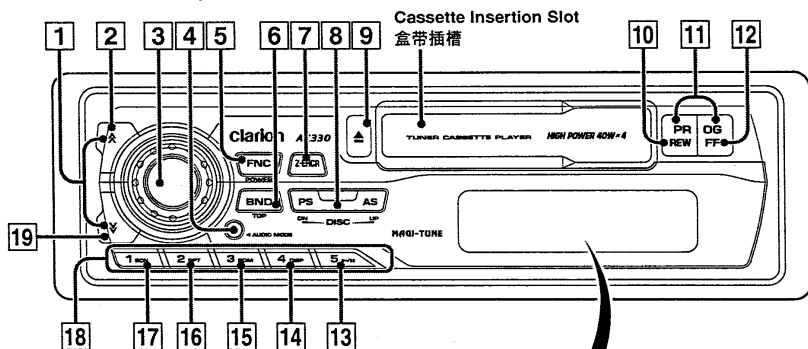

DISPLAY / 显示屏

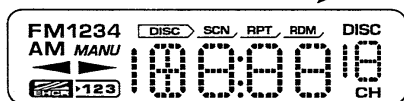

3. BUTTON TERMINOLOGY

Note:

• Be sure to read this chapter referring to the front diagrams of chapter 2. CONTROLS on page 3 (unfold).

- | | |
|--|-----------------------------------|
| 1 Up and Down (▲ and ▼) Buttons | 10 REW (◀◀) Button |
| 2 Function Button 1 | 11 PROG (Program) Button |
| 3 Rotary Knob | 12 FF (▶▶) Button |
| 4 A-M (Audio Mode) Button | 13 Play/Pause (▶/) Button |
| 5 FNC (POWER) Button | 14 DISP (Display Selector) Button |
| 6 BAND (Tuning Mode) Button | 15 RDM (Random play) Button |
| 7 Z-EHCR (Z-Enhancer) Button | 16 RPT (Repeat play) Button |
| 8 PS/AS (Preset Station Scan/Automatic Station Store) Button | 17 SCN (Scan play) Button |
| DISC Up and Down Button | 18 Preset Buttons |
| 9 Eject (▲) Button | 19 Function Button 2 |

4. CASSETTE PRECAUTIONS AND CARE

1. Tape slack can lead to operating difficulties. Remove tape slack before inserting a cassette, particularly when using C-90 or prerecorded cassettes.
2. Use C-30 to C-90 cassettes. Avoid using C-120 or longer cassettes (The very thin tape may stretch or break).
3. Clean the head periodically with a good commercial head cleaner. Avoid touching the head with magnetic or hard objects.
4. Do not oil the cassette mechanism.
5. Always remove the cassette from the mechanism when not in use. Exposure to direct sunlight, extreme temperatures or high humidity may damage cassettes.

5. OPERATION

Note:

- Be sure to read this chapter referring to the front diagrams of chapter 2. CONTROLS on page 3 (unfold).

Basic Operation

CAUTION

When this unit is turned on, starting and stopping the engine of a car with its volume raised to the maximum level may harm your hearing. Be careful about adjusting the volume.

- 1) Press the FNC button [5].
 - * To turn the power off, press the POWER button for at least 1 second.
- 2) Press the FNC button [5] to select the operation mode. The mode switches as follows each time the FUNC button is pressed:
Radio → Tape → CD changer → Radio
 - * If a component is not connected, that operation mode cannot be selected.
 - * "CASS" appears when no tape is loaded in the source unit, and "DISC" appears when no disc is loaded in the CD changer.
- 3) Turning the Rotary knob [3] clockwise increases the volume; turning it counterclockwise decreases the volume.
 - * The volume level is from 0 (minimum) to 33 (maximum).

Audio Mode Adjustments

Press the A-M button [4] to select the adjustment mode. The mode switches as follows each time the A-M button is pressed:

BASS → TREB → BAL → FAD → Previous mode

Adjusting the Bass

- 1) Press A-M button [4] and select "BASS".
- 2) Turning the Rotary knob [3] clockwise emphasizes the bass; turning it counterclockwise attenuates the bass.
 - * The factory default setting is "0". (Adjustment range: -6 to +6)
- 3) When the adjustment is complete, press A-M button [4] several times until the function mode is reached.

Adjusting the Treble

- 1) Press A-M button [4] and select "TREB".
- 2) Turning the Rotary knob [3] clockwise emphasizes the treble; turning it counterclockwise attenuates the treble.
 - * The factory default setting is "0". (Adjustment range: -6 to +6)
- 3) When the adjustment is complete, press A-M button [4] several times until the function mode is reached.

Adjusting the Balance

- 1) Press A-M button [4] and select "BAL".
- 2) Turning the Rotary knob [3] clockwise emphasizes the sound from the right speaker; turning it counterclockwise emphasizes the sound from the left speaker.
 - * The factory default setting is "0". (Adjustment range: L9 to R9)
- 3) When the adjustment is complete, press A-M button [4] several times until the function mode is reached.

Adjusting the Fader

- 1) Press A-M button [4] and select "FAD".
- 2) Turning the Rotary knob [3] clockwise emphasizes the sound from the front speakers; turning it counterclockwise emphasizes the sound from the rear speakers.
 - * The factory default setting is "0". (Adjustment range: F9 to R9)
- 3) When the adjustment is complete, press A-M button [4] several times until the function mode is reached.

Setting the Z-enhancer

This unit comes with three types of sound tone effects stored in memory. Select the one you prefer.

* The factory default setting is "Z-EHCR OFF".

Each time you press Z-EHCR button [7], the tone effect changes in the following order.

"Z-ENHANCER 1" → "Z-ENHANCER 2" →

"Z-ENHANCER 3" → "Z-EHCR OFF" →

"Z-ENHANCER 1"...

- Z-ENHANCER 1: bass emphasized
- Z-ENHANCER 2: treble emphasized
- Z-ENHANCER 3: bass and treble emphasized
- Z-EHCR OFF: no sound effect

Switching the Display

While pressing the BAND button [6] press the DISP button [14] to enter the clock display mode. Main display → Clock display → Main display

Setting the Clock

- 1) While pressing the BAND button [6], press the DISP button [14] to enter the clock display mode.
- 2) While pressing the BAND button [6], press and hold the DISP button [14] for 2 seconds or more. This enables the clock editing mode.
 - * The editable fields will be indicated when the display flashes.
- 3) To move between the hour and minute fields, use the Up (hour) and Down (minute) buttons [1].
- 4) To store the clock setting, press the BAND button [6].

Notes:

- If you select another operation mode before completing the above procedure, the clock setting operation will be canceled.
- Removing the vehicle's battery for a check or repair will cause the clock to reset to 1:00. Set the clock again if this happens.

Tape Operation

Loading Tapes

Insert the cassette tape into the Cassette insertion slot with the side on which the tape is exposed facing the right. Playback starts automatically.

* When the end of the cassette tape is reached, the auto reverse mechanism is activated and the other side of the tape begins playing automatically.

Note:

- Fully insert the cassette tape into the cassette insertion slot.

Listening to a tape which is already loaded

Press the FUNC button [5] to select the tape mode. Playback begins automatically.

Ejecting Cassette Tapes

Press the Eject button [9]. The cassette tape is ejected.

* The radio mode is selected automatically 4 seconds after ejecting the tape.

Fast-Forwarding and Rewinding

Use the FF button [12] and REW buttons [10].

▶▶: Press this to fast-forward the tape.

◀◀: Press this to rewind the tape.

* It is possible to listen to the radio during fast-forward, rewind or search operations.

Switching to the Other Side of the Tape

Press the PROG button [11] both the FF button [12] and REW button [10] together at the same time. Playback is switched automatically to the other side of the cassette tape.

Radio Operation

FM Reception

For enhanced FM performance the **MAGI-TUNE** tuner includes signal actuated stereo control and Multipath noise reduction circuits.

Listening to the Radio

- 1) Press the POWER button [5] to select the radio mode. The radio turns on.
- 2) To tune to a desired preset station, first press the BAND button [6] and select FM1, FM2, FM3, FM4 or AM.
The band changes as follows each time the BAND button is pressed:
FM1 → FM2 → FM3 → FM4 → AM → FM1
- 3) Use the corresponding Preset buttons [18] to select the desired station.

Seek Tuning

- 1) Press the BAND button [6] and select the desired band.
- 2) Press the Up or Down buttons [1] to seek Up or Down the frequency band. Seek tuning automatically stops when a station is found.

Manual Tuning

- 1) Press the BAND button [6] to select the desired band.
- 2) Press and hold the BAND button for more than 2 seconds. "MANU" turns ON and the manual tuning mode is selected.
- 3) Use the Up and Down buttons [1] to manually tune up or down the desired frequency band.

Presetting Stations

A total of 25 stations can be preset, 5 each for the FM1, FM2, FM3, FM4 and AM bands.

Note:

- When a station is preset, the station previously stored in the memory at that position is cleared.

Presetting stations manually

- 1) Press the BAND button [6] to select the band at which to store the station.
- 2) Use the Up and Down buttons [1] to tune in the station to be preset.
- 3) Press and hold the corresponding Preset button [18] for at least 2 seconds to store the station into memory.

Auto store function (Automatic Station Store)

- 1) Press the BAND button [6] to select the band at which to store the stations.
- 2) Press and hold the AS button [8] for at least 2 seconds. Stations with good reception are automatically stored at preset to the five buttons [18] 1 to 5
* If there are fewer than 5 stations with good reception, the stations previously stored at the remaining buttons are not cleared.

Preset Scanning (Preset Station Scan)

When the PS button [8] is pressed, the preset memory numbers flash and the stations are tuned in for 7 seconds each in the order in which they were stored. Press the PS button again to cancel the preset scanning mode.

Note:

- The auto store mode is set if the PS button is pressed for more than 2 seconds.

CD Changer Mode Operation

Listening to the Disc

Press the FUNC button [5] and select the CD changer mode, then the CD starts playing.



CD CHANGER MODE OPERATION

* Press the DISP button [14], then the display will show the play time.

Track No. → Play time → Track number

Stopping (pausing) Playback

Press the Play/Pause button [13].

Press the Play/Pause button [13] again to resume playback.

Selection of CDs

Press the Disc Up/Down button [8] to select the CD you wish to play.

Selection Tracks (songs)

Press the Up/Down button [1].

⤴ : Playback will start from the next track.

⤵ : Playback will start from the beginning of the track currently playing. When this button is pressed again, the CD will play from the previous track.

Fast-Forward and Fast-Backward

⤴ : To fast-forward

⤵ : To fast-backward

* Press and hold the Up/Down button [1] for 1 second or longer will move forward or backward 5 times faster than normal play, and pressing it for 3 seconds or longer will do the operation 30 times faster.

Scan Play (Intro Music Scan)

Press the SCN button [17], then the display shows "SCN", then the CD will play the first 10 seconds of all the tracks of all CDs. Press the SCN button [17] again to disengage the unit from scan play.

* A scan play will start from the track following the one currently playing.

Disc scan play

Press and hold the SCN button [17] for 2 seconds or longer, then the display will show "DISC" and "SCN", and plays the first 10 seconds of the first tracks of all the CDs in the CD changer.

Press the SCN button [17] again to disengage the unit from disc play.

* A scan play will start from the first tracks of next CDs following the one currently playing.

Repeat Play

Press the RPT button [16], then the display shows "RPT", then the track currently playing will be played repeatedly. Press the RPT button [16] again to disengage the unit from repeat play.

Disc repeat play

Press and hold the RPT button [16] for 2 seconds or longer, then the display shows both the "DISC" and "RPT", then the disc currently being played will be played repeatedly.

Press the RPT button [16] again to disengage the unit from disc repeat play.

Random Play

Press the RDM button [15], then the display will show "RDM", then the entire tracks on the disc will be played at random.

Press the RDM button [15] again to disengage the unit from disc random play.

6. TROUBLESHOOTING

Problem	Cause	Measure
Power does not turn on (or no sound is produced)	Fuse is blown.	Replace with a fuse of the same amperage as the old fuse.
	Connections are improper.	Read the attached "Installation/Wire Connection Guide" once again and wire properly.
Sound quality is poor.	Playback head is dirty.	Use a cleaning tape, etc. to clean the head.
No sound while unit can be operated.	Power ANT lead is shorted to the ground.	Turn the unit off, first. Remove all connecting wires from the power ANT lead, and turn the unit on, then re-connect a wire one by one to the power ANT lead. When sound is muted again, check the unit with a wire connected last.

7. ERROR DISPLAYS

- To protect the system, this unit has been equipped with self diagnostic functions. If a fault arises, a warning is issued by various error displays. Follow the corrective measures and remove the fault.

Error Display	Corrective Measure
Er 2	This error display indicates that a fault has arisen in the mechanism of the source unit or CD changer (for example, the disc cannot be changed or ejected). → Check the source unit and CD changer.
Er 3	This error display indicates that the pickup focus is off because of a scratched disc or some other factor during source unit or CD changer play. → Check the compact disc.
Er 6	This indicates that the CD's TOC (table of contents) cannot be read, for example because the selected disc is upside-down.

8. SPECIFICATIONS

FM Tuner

Frequency Range.....87.5 MHz to 108 MHz
Usable Sensitivity.....11 dBf
50 dB Quieting Sensitivity.....17 dBf
Alternate Channel Selectivity.....75 dB
Stereo Separation (1 kHz).....35 dB
Frequency Response (± 3 dB)
.....30 Hz to 15 kHz

AM Tuner

Frequency Range.....531 kHz to 1,602 kHz
Usable Sensitivity.....25 μ V

Tape

Wow & Flutter (WRMS).....0.4%
Channel Separation (1 kHz).....35 dB
Signal to Noise Ratio.....120 μ s (normal): 40 dB
Frequency Response (± 3 dB)
120 μ s (normal).....30 Hz to 16 kHz

Power Amplifier

Maximum Power Output.....160 W (40 W \times 4ch)
Continuous Average Power Output
.....14 W \times 4, into 4 Ω , 20 Hz to 20 kHz,
1% THD

Pre-Amplifier

Bass Control Action (100 Hz)..... ± 6 dB
Treble Control Action (10 kHz)..... ± 6 dB

General

Power Supply Voltage
.....14.4 V DC (10.8 V to 15.6 V allowable)
Current Consumption..... Less than 10 A
Speaker Impedance
.....4 Ω (4 Ω to 8 Ω allowable)
Weight.....2.87 lb. (1.3 kg)
Dimensions
.....7" (178 mm) Width \times 2" (50 mm) Height \times
6" (152 mm) Depth

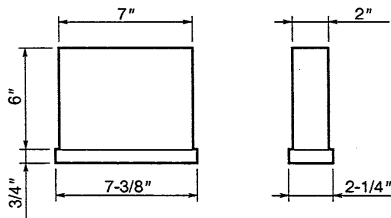

Notes:

- Specifications comply with EIA Standards.
- Specifications and design are subject to change without notice for further improvement.

Memo

English